

TLP Pro 300M Series • Setup Guide

IMPORTANT:
Go to www.extron.com for the complete user guide and installation instructions before connecting the product to the power source.

Overview

The TLP Pro 300M Series touchpanels are 3.5 inch capacitive touchscreens with a resolution of 320x480 (HVGA) and 18-bit color depth. They can be mounted, in a portrait orientation, to a standard 1-gang US electrical box.

This guide provides instructions for experienced installers to mount and set up these touchpanels. For complete instructions, see the *TLP Pro 300 Series User Guide*, at www.extron.com.

Setup Checklist

Get Ready

- ☐ Download and install the latest version of the following software:
 - ☐ **GUI Designer** — for designing layouts for Extron TouchLink® Pro touchpanels and third party touch interfaces
 - ☐ **Global Configurator® Professional** or **Global Configurator Plus** — for setting up and configuring the control processor and touchpanel
 - ☐ **Toolbelt** — provides device discovery, device information, firmware updates, and configuration of network settings, system utilities, and user management for TouchLink Pro devices
 - ☐ **Global Scripter®** — provides an integrated development environment for Extron control systems programming

NOTE: All four software programs are available from www.extron.com.

- ☐ Obtain the following network information from your network administrator:
 - ☐ **DHCP status** (on or off). If DHCP is off, you must also obtain:
 - ☐ **IP address**
 - ☐ **Subnet mask**
 - ☐ **Gateway**
 - ☐ **Username** — This can be either admin or user.
 - ☐ **Password** — The factory configured passwords for all accounts on this device have been set to the device serial number. Passwords are case sensitive.

NOTE: If the device is reset to default settings, the password will be the default password configuration. The default password is **extron**.

- ☐ Make a note of the touchpanel MAC address.

Mount and Cable All Devices

- ☐ Mount the units. There are several mounting options for TouchLink Pro touchpanels (see **Mounting** on the next page).
- ☐ Connect the touchpanel to a Power over Ethernet injector (not provided). Extron recommends the XTP PI 100 power injector, which must be purchased separately.
- ☐ Connect the power injector to the LAN and power it on.

ATTENTION:

- Do not power on the touchpanels until you have read the **ATTENTION** in the “Rear Panel Features” section of the *TLP Pro 300M Series User Guide*.
- Ne branchez pas les écrans tactiles avant d’avoir lu la mise en garde dans la section « Rear Panel Features » du *TLP Pro 300M Series User Guide*.

Set up the Touchpanels for Network Communication

- ☐ Connect the PC that you are using for setup, the control processor, and touchpanel to the same Ethernet subnetwork.
- ☐ Use the **Setup Menu** (see page 4) or Toolbelt software to set the DHCP status and, if necessary, the IP address, subnet mask, gateway, and related settings for the touchpanel.

Configure the Touchpanels

- ☐ Create a graphical user interface with GUI Designer (see *GUI Designer Help File* for step-by-step instructions).
- ☐ Associate functions with the graphical user interface features by configuring (see the *Global Configurator Help File*) or programming (see the *Global Scripter Help File*) the system. Global Scripter provides an Extron-exclusive Python library (ControlScript®) and Global Scripter modules to get you started.

TLP Pro 300M Series • Setup Guide (Continued)

Mounting

The following instructions are provided for experienced installers to mount the TLP Pro 300M touchpanel. The touchpanel can be wall-mounted, either using a standard 1-gang, UL-listed electrical box (must be purchased separately), or directly into drywall or furniture. Suitable mounting accessories can be found at www.extron.com.

ATTENTION:

- Do not install touchpanels in a fire resistant rated wall or partition assembly.
- Ne pas installer les écrans tactiles sur un mur protégé par un dispositif coupe-feu ou dans une cloison.
- All structural steps and electrical installation must be performed by qualified personnel in accordance with local and national building codes and electrical codes.
- Toute étape structurelle et installation électrique, doit être effectuée par un personnel qualifié, conformément aux codes du bâtiment, aux codes incendie et sécurité, et aux codes électriques, locaux et nationaux.

Mounting With a UL-listed Electrical Box

The UL-listed electrical junction box must be purchased separately.

1. Cut a hole for the junction box at the required location.
2. If you are using the provided tether kit to deter theft, one loop of the tether kit should be secured to a wall stud with a screw (not provided)
3. Run cables to the installation site as required.
4. Pass the other end of the tether kit and the cables through a knock-out in the junction box.
5. Install the junction box by following the instructions provided by the manufacturer.
6. Secure the metal mounting plate to the junction box, using the provided screws.
7. Attach cables to the back of the TLP Pro 300M (see [Rear Panel Features](#) on page 3).
8. If a tether kit is being used, loosen the security screw on the back panel (see [figure 4](#), **F**, on page 3) just enough to insert the loop of the tether kit.
9. Tighten the screw to clamp the tether in place.
10. Attach the touchpanel to the metal mounting plate. The touchpanel is held in place by magnets.

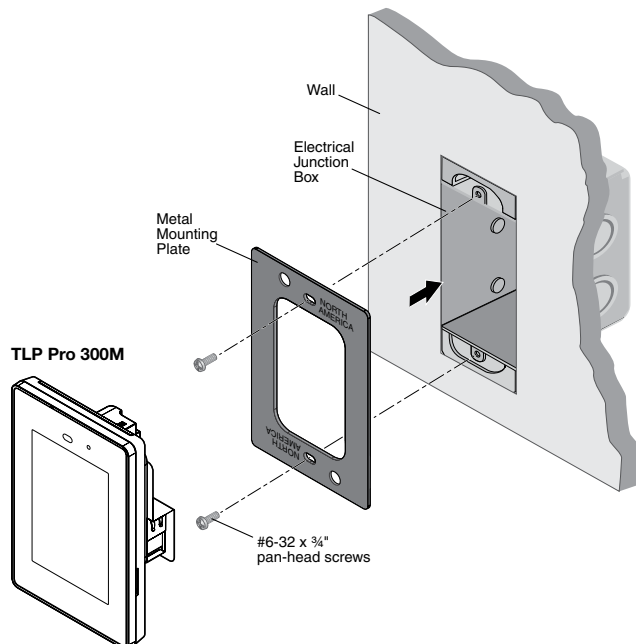

Figure 1. Mounting to a UL-listed Electrical Box

Mounting to Drywall or Furniture

Figure 2 shows how to mount the TLP Pro 300M in drywall. Follow the same procedure to mount into furniture.

1. Download the TLP Pro 300M Cut-out Template from the Extron website (www.extron.com). Ensure that it is printed at 100% size, with no scaling.
2. Remove the cut-out area from the template.
3. Attach the template to the wall in a suitable location, using a level to ensure the template is aligned correctly.
4. Use the template to mark and remove the cut-out area (1) and drill two holes (2) for the screws that secure the toothed clamping plates.
5. If you are using a tether kit to deter theft, one loop of the tether kit should be secured to a wall stud.
6. Run cables to the installation site as required.
7. Secure the metal mounting plate to the clamping plates, using the provided screws. As the screws turn they tighten the grip of the clamping plates on the inside surface of the drywall.
8. Attach the tether kit and cables to the touchpanel and secure the touchpanel to the mounting plate as described in steps 7 through 10 in the previous section.

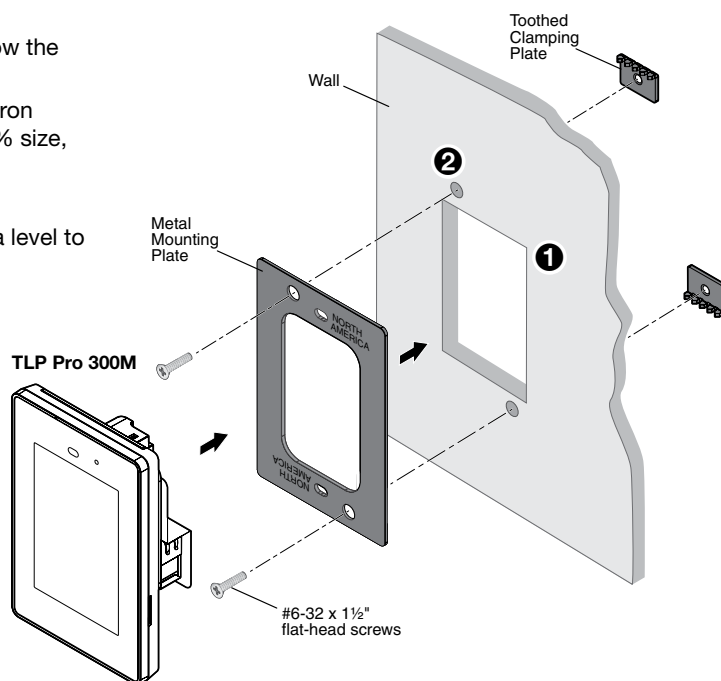

Figure 2. Mounting to Drywall or Furniture

Front Panel Features

Figure 3 shows the TLP Pro 300M Series front panel.

- A LCD touchscreen** — The 3.5-inch, 320x480 resolution touchscreen is made with Corning® Gorilla® Glass, which is stronger and more scratch-resistant than standard glass, while maintaining touch sensitivity, color saturation, and brightness.
- B Motion sensor (2)** — Detects motion between three to five feet from the touchpanel, and at least 15° from the center axis.
- C Light sensor** — Monitors ambient light level and adjusts screen brightness, based on the settings configured using the [Setup Menu](#) (see the next page).

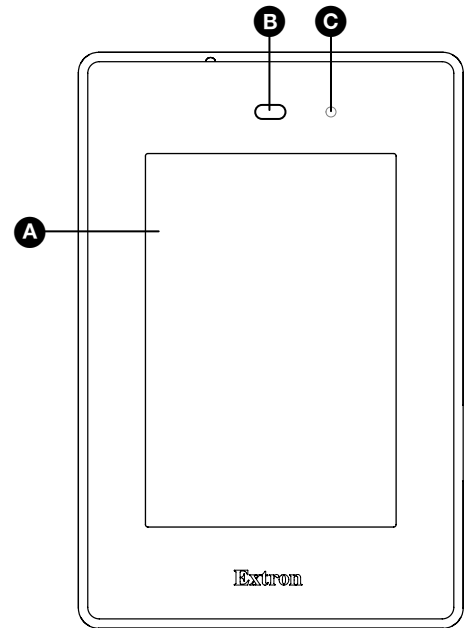

Figure 3. TLP Pro 300M Front Panel

Rear Panel Features

Figure 4 shows the TLP Pro 300M Series rear panel.

- A Status light** — Can be programmed to provide system feedback:
 - Light red or green
 - Blink or light continuously
 For information about configuring or programming this light, see the *Global Configurator Help File* or the *Global Scriptor Help File*.
- B Reset LED** — Provides feedback about the reset status when the user presses the **Reset** button (for an overview, see [Reset Modes: a Brief Summary](#), on the next page).
- C Reset Button** — Pressing the **Reset** button allows the unit to be reset in any of three different modes (see [Reset Modes: a Brief Summary](#)).
- D Menu Button** — Activates the setup menu (see [Setup Menu](#)).
- E Serial Number Label** — The serial number is on a label on the side wall of the back enclosure. The factory configured passwords for all accounts on this device have been set to the device serial number. Passwords are case sensitive.

NOTE: If the device is reset to default settings, the password is the default password configuration. The default password is extron.

- F Security Screw** — Used to attach provided tether kit. It requires a Torx screwdriver (size T8).
- G LAN/PoE Connector** — Connect the touchpanel to a PoE power injector (not provided) using a twisted pair cable, terminated with an RJ-45 connector. Connect the power injector to the LAN through a network switch. An Extron IP Link Pro control processor must also be connected to the same network as the TouchLink Pro touchpanel. See [Connecting the Power Injector](#) on the next page.

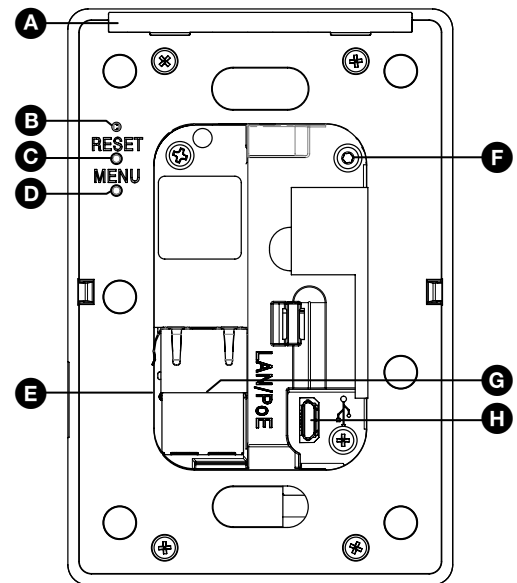

Figure 4. TLP Pro 300M Rear Panel

ATTENTION:

- The TLP Pro 300M is Power over Ethernet (PoE 802.3af, class 2) compliant. Do not power on the touchpanels until you have read the Attention in the “Rear Panel Features” section of the *TLP Pro 300M Series User Guide*.
- Le TLP Pro 300M supportent l'alimentation via Ethernet (PoE 802.3af, classe 3). Veuillez lire la partie « Attention » dans la section « Rear Panel Features » du *TLP Pro 300M Series User Guide*, avant de mettre sous tension les écrans tactiles.

NOTE: These touchpanels are shipped without a power injector. The power injector must be purchased separately.

- H USB Port** — One micro-B receptacle supports high-speed USB 2.0.

TLP Pro 300M Series • Setup Guide (Continued)

Connecting the Power Injector

The power injector must be purchased separately. Figure 5 shows the Extron XTP PI 100. Your power injector may look different.

Connect a straight-through Ethernet cable from the power injector to a switch or router (❶). This cable carries network information from the switch or router to the power supply input. A second straight-through cable (❷) carries the network information and 48 VDC from the power injector to the touchpanel LAN/PoE connector (see figure 4, ❸, on the previous page). Connect the IEC power cord to a convenient 100 VAC to 240 VAC, 50-60 Hz power source (see figure 5, ❹).

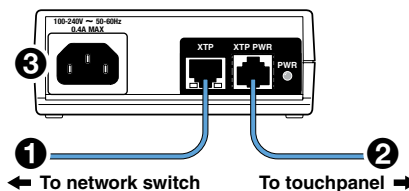

Figure 5. Connecting to a Power Injector

Reset Modes: a Brief Summary

The TLP Pro 300M Series touchpanels offer the following reset modes:

- **Use Factory Firmware:** Use this mode with Toolbelt software to replace firmware in the event of conflicts arising from uploading a firmware update. Press and hold the **Reset** button (see figure 4, ❷) while applying power to the unit.
- **Reset All IP Settings:** Use this mode to reset all network settings without affecting user-loaded files. Press and hold the **Reset** button until the Reset LED (❸) blinks twice (about 6 seconds). Release and momentarily press the **Reset** button again.
- **Reset to Factory Defaults:** Use this mode to return the touchpanel to factory default settings, including passwords. Press and hold the **Reset** button until the Reset LED blinks three times (about 9 seconds). Release and momentarily press the **Reset** button again.

NOTES:

- The factory configured passwords for all accounts on this device have been set to the device serial number. Passwords are case sensitive.
- If the device is reset to default settings, the password will be the default password configuration. The default password is extron.

- **Enable or Disable the DHCP Client:** Use this mode to toggle between DHCP enabled and DHCP disabled. Press the **Reset** button five times, consecutively. After the fifth press, do not press the button again within 3 seconds. If DHCP was enabled, it is now disabled and the Reset LED blinks three times. If DHCP was disabled, it is now enabled and the Reset LED blinks six times.

Setup Menu

Figure 6 shows the Setup menu Status screen for the TLP Pro 300M.

Press the **Menu** button (see figure 4, ❶) to open the Setup menu. Any of the six available screens (Status, Network, Display, Audio, Project Information, and Advanced) can be accessed by pressing the menu button in the top left corner of the screen (for more information, see the *TLP Pro 300M Series User Guide*).

It may be necessary to scroll down to see all the information on the page (for example, see the Status screen in figure 6).

≡ STATUS	EXIT
Device Information	
Model	TLP Pro 300M
Part Number	60-1667-02
Firmware	1.00.0001-003
Bootloader	1.00.0002
Network	>
✓ IP Address	192.168.254.251

Figure 6. Setup Menu: Status Screen for TLP Pro 300M

For information on safety guidelines, regulatory compliances, EMI/EMF compatibility, accessibility, and related topics, see the [Extron Safety and Regulatory Compliance Guide](#) on the Extron website.

For information about replacing and disposing of batteries, see the *TLP Pro 300M Series User Guide* at www.extron.com.