

This setup guide contains installation information about the SF 26CT LP SoundField® low-profile XD 2-way speaker. This speaker can be installed by a single-trade installation procedure or by a multi-trade installation procedure (see the *SF 26CT LP User Guide*, available at www.extron.com, for details). The entire assembly is plenum rated.

⚠ WARNING: Potential risk of severe injury. Installation and service must be performed by authorized personnel only.
AVERTISSEMENT : Risque potentiel de blessure grave ou de mort. L'installation et l'entretien doivent être effectués par le personnel autorisé uniquement.

NOTE: Installation of conduit and conduit adapters must conform to all applicable building codes and local ordinances.

Installing the SF 26CT LP in a Suspended Ceiling

For hard ceiling installations, see the *SF 26CT LP User Guide*.

1. **Remove power** from all devices.

NOTE: If the grille is to be painted, see the user guide for more information.

2. **Cut a hole for the SF 26CT LP.** Use the provided cutout template to outline the hole to be cut in the ceiling tile, as described below.

- a. Remove the ceiling tile, and draw diagonal lines across it from opposite corners to locate its center. Mark the intersection where the lines cross.
- b. Position the center hole of the cutout template directly over the center of the tile, marked in step 2a.
- c. Trace a circle on the ceiling tile around the cutout template.
- d. Cut out the circle traced in the ceiling tile.
- e. Replace the ceiling tile in the ceiling.

3. **Attach two V-rails and one C-ring** above the hole cut in step 2, as described below.

- a. Assemble two V-rail half sections so that they become one single piece by fitting the tab of one end into the slot of the other end. Open the V-rail until it locks together, as shown. Repeat this procedure for the other V-rail.

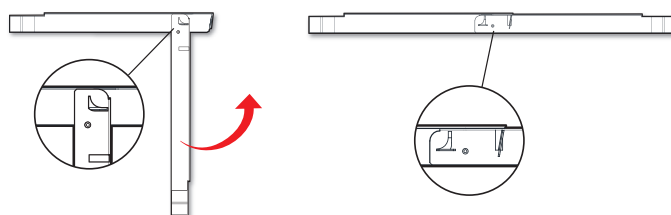
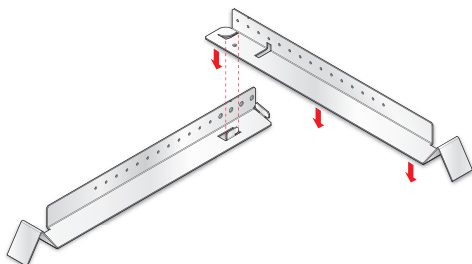

- b. Remove a ceiling tile adjacent to the tile with the hole.
- c. Place both assembled V-rails on the cut ceiling tile and position them equally on either side of the hole. The ends of the V-rails go over the ceiling grid.
- d. Position the C-ring assembly on the two V-rails so that the C-ring is centered over the hole.

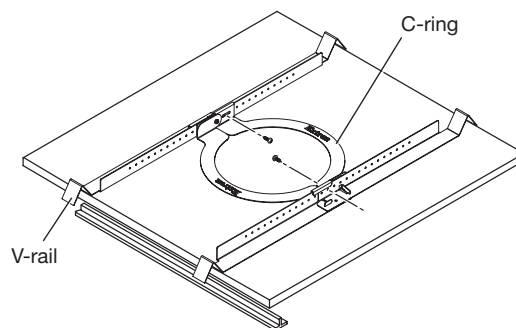

- e. Secure the C-ring to the V-rails using two screws.
4. **Route the speaker wires** through the ceiling tile hole.
 5. **Configure the locking arms for thicker ceilings (optional).**

Four speaker locking arms are used to secure the speaker to ceiling tiles up to 2.25 inches (5.72 cm) thick. The locking arms are equipped with removable inserts that accommodate ceiling tiles of up to 1.5 inches (3.81 cm) in thickness. For ceiling tiles thicker than 1.5 inches, the locking arm inserts must be removed.

SF 26CT LP • Setup Guide (Continued)

To remove the insert:

- a. Using a screwdriver, rotate the locking arm so that the insert can be accessed

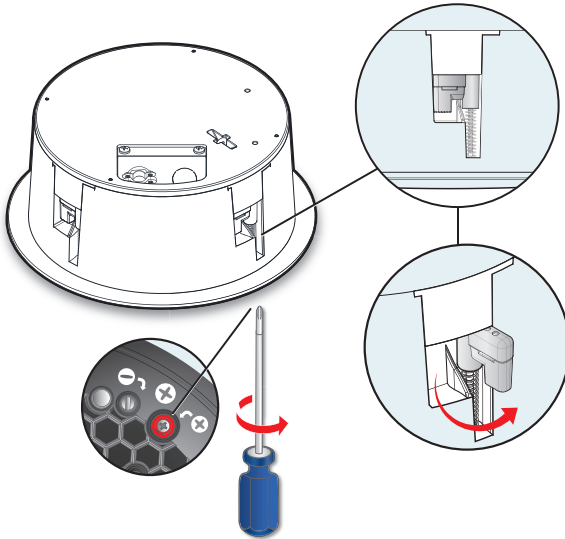

- b. Use a small screwdriver to pry and separate the insert from the locking arm, as shown below.

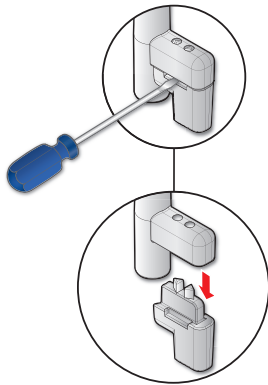

- c. Repeat this process for the remaining three locking arms.
- d. Rotate all four locking arms back into the speaker.

6. Configure the cable/conduit access plate and captive screw connector, as described below.

- a. The cable/conduit access plate has one alternate hole available covered by a knockout. This hole may be used for loop out when using conduit. If this knockout needs to be removed, do the following:
 - i. With the cable/conduit access plate still attached to the speaker, place the tip of a flat-head screwdriver against the knockout.
 - ii. Lightly tap the screwdriver with a hammer to remove the knockout.
- b. Loosen the three cable/conduit access plate screws and remove the cover.

Remove the terminal cover. Alternate Knockout

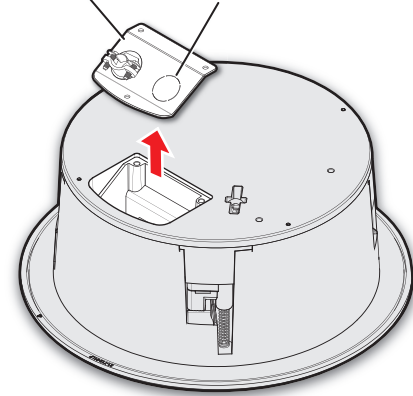

- c. Configure the cable/conduit access plate.
 - **When not using conduit:** Route the speaker wires through the cable clamp.
 - **When using conduit:** Remove the cable clamp and install the conduit into the access plate opening. Secure the conduit to the plate with the locking nut and pull the speaker wires from the conduit.
- d. Strip 0.2 inches (5 mm) from the wire ends.
- e. Use one of the following three methods to attach the speaker wires to the captive screw connector (depending on the configuration).

Wiring Multiple Speakers Using Loop-through

When a chain of speakers is wired this way, disconnecting one speaker removes power from all downstream speakers

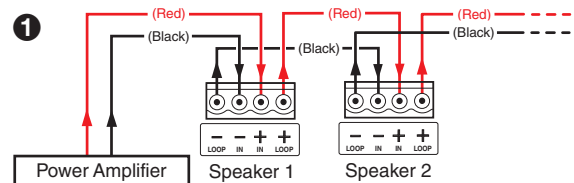

Wiring Multiple Speakers in Parallel

When a chain of speakers is wired this way, disconnecting one speaker does not remove power from the remaining speakers in the chain.

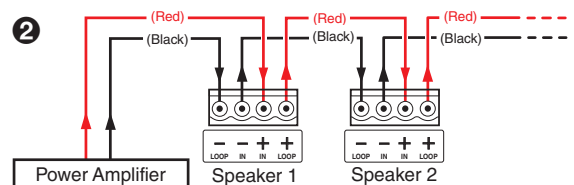

Wiring a Single Speaker

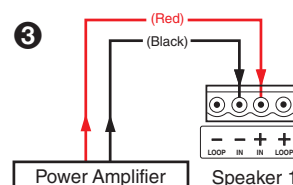

Number of Wires per Connection Point	Maximum Wire Gauge
1	12 AWG
2	16 AWG
4	18 AWG

ATTENTION:

- Do not tin the wire leads before installing into the connector. Tinned wires are not as secure in the connector and could be pulled out.
- Ne pas étamer les conducteurs avant de les insérer dans le connecteur. Les câbles étamés ne sont pas aussi bien fixés dans le connecteur et pourraient être retirés.

- f. Insert the captive screw plug into the four-pole receptacle of the speaker.

Using a cable clamp:

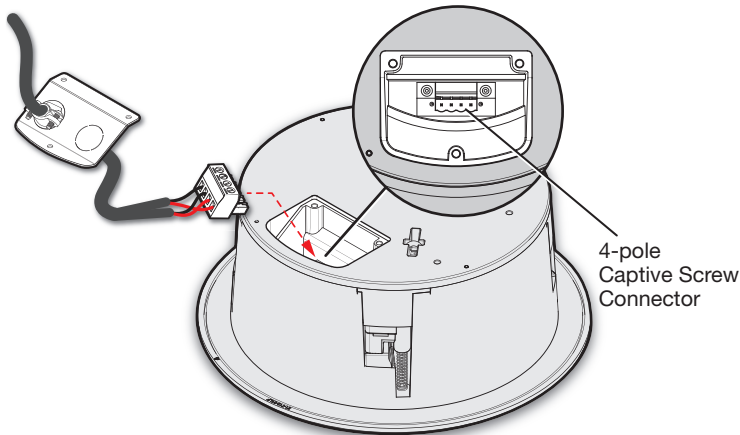

- g. **Using a conduit adapter:**

Flexible Conduit Adapter

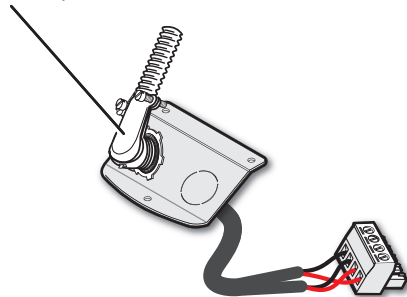

- h. Replace the cable/conduit access plate and tighten the three screws.
- i. Tighten the cable clamp if it was used.

7. Mount the speaker

The speaker can be installed into rigid material (mineral tile, gypsum board, sheetrock, etc.) or soft material, such as fiberglass.

- Insert the speaker through the bottom of the hole in the ceiling tile that was cut in [step 2](#) with the wires out of the way.
- Clamp the speaker to the C-ring by using a Phillips screwdriver to tighten the four locking arms to the C-ring.

NOTE: The screw hole locations are marked on the front baffle with a Phillips head screw symbol. Use these holes to tighten the locking arms.

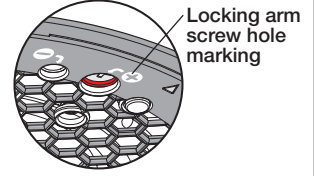

Tightening the locking arms into rigid material:

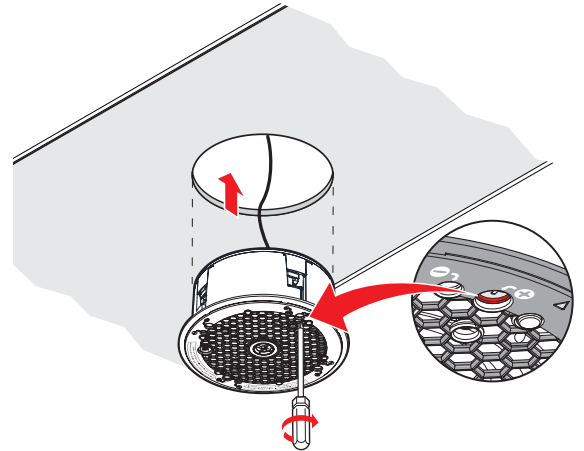

NOTE: Each of the four locking arm screws uses an Opti-Torque™ indicator. The indicator releases a red plastic ring onto the screwdriver once the screw is tightened to the correct torque. Stop tightening any further when this occurs to avoid overtightening the locking arms to the C-ring.

ATTENTION:

- To avoid damaging the speaker, do not overtighten the four locking arm screws.
- Pour éviter d'endommager l'enceinte, ne serrez pas trop les quatre vis.

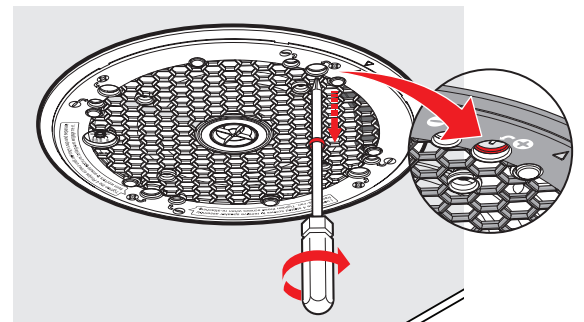

Tightening the locking arms into soft material:

Because fiberglass ceilings and other soft materials are not as rigid as mineral tiles and other hard materials, the Opti-Torque indicator should not be used as a tightening guide due to the risk of overtightening.

ATTENTION:

- To avoid damaging or deforming soft ceiling material, tighten the locking arms to secure the speaker, but short of causing the speaker to deform the flat mounting surface of the ceiling, as seen from below.
- Afin de ne pas endommager ni d'altérer un plafond souple, serrez les bras de verrouillage pour sécuriser l'enceinte, en veillant cependant à ce que l'unité ne cause l'altération de la surface de montage plane du plafond, comme illustré ci-dessous.

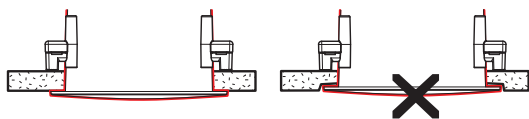

8. If required, attach a secondary support line.

- Connect a secondary support line to the support loop on the back of the speaker enclosure, as shown here.

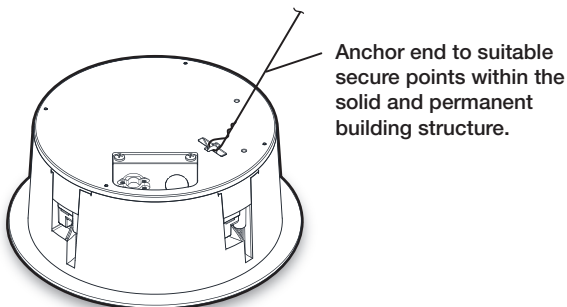

ATTENTION:

- Do not allow any slack in the secondary support line.
- Ne laissez pas de mou au niveau du filin de sécurité secondaire.

- Replace the adjacent tile that was removed in **step 3**.

9. Set the rotary tap selector switch to the appropriate setting using a small screwdriver.

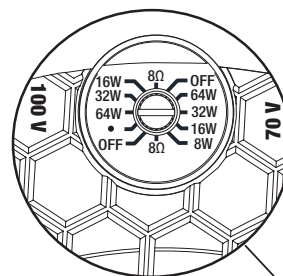

Adjust the Tap Selector

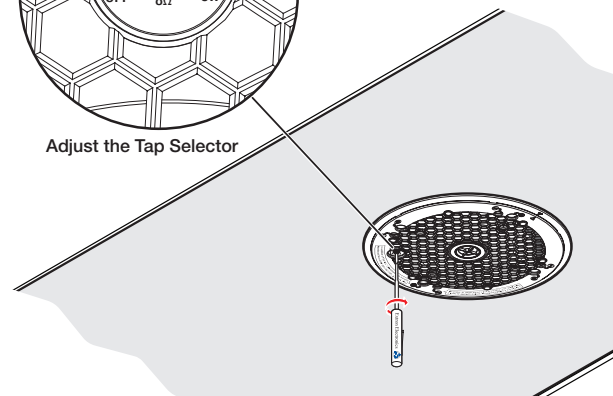

- 10. Install the grille.** Position the grille so that it covers the baffle of the speaker. Six small magnets secure the grille in place.

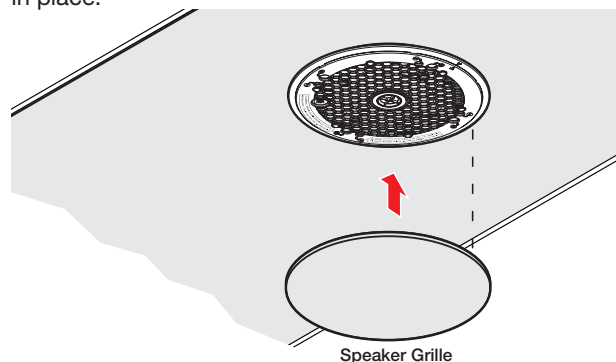

ATTENTION:

- When setting the taps for a distributed (high impedance) system, do not tap the system above the rated power of the amplifier.
- When connecting multiple speakers in 8-ohm mode, be sure that the combined rated impedance does not equal a value less than the minimum rated impedance of the amplifier.
- Lors de la mise en place des capteurs pour un système distribué (haute impédance), n'exploitez pas le système au delà du niveau d'alimentation de l'amplificateur.
- Lors de la connexion de plusieurs enceintes en mode 8 ohm, assurez vous que le niveau d'impédance combinée ne soit pas équivalent à une valeur inférieure à l'impédance minimum de l'amplificateur.